

HODGE MARINE

1857 NW 21ST STREET

POMPANO BEACH, FLORIDA 33069

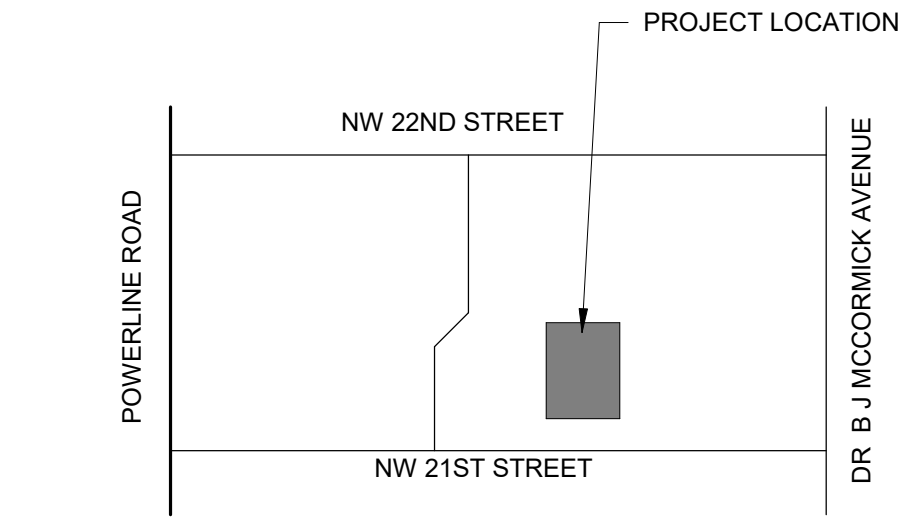

VICINITY MAP
N.T.S.

SHEET INDEX

SHEET #	SHEET NAME	REV #	DATE
GENERAL			
G000	COVER SHEET		
G001	GENERAL INFORMATION		
G002	CODE INFORMATION		
SURVEY			
S-1	SURVEY		
SITE PLAN			
SP-1	SITE PLAN - EXISTING		
SP-2	SITE PLAN - PROPOSED		
ARCHITECTURAL			
A101	LIFE SAFETY PLAN - FIRST FLOOR		
A102	LIFE SAFETY PLAN - MEZZANINE		
A121	FLOOR PLAN - FIRST FLOOR		
A122	FLOOR PLAN - MEZZANINE		
A141	ROOF PLAN		
A200	EXTERIOR ELEVATIONS		
A201	EXTERIOR ELEVATIONS		
A300	BUILDING SECTIONS		
A500	DETAILS - BUILDING		
A600	DOOR & WINDOW SCHEDULE		
LANDSCAPE			
L001	IRRIGATION PLAN		
L001	LANDSCAPE PLAN		
L002	SPECIFICATIONS AND DETAILS		
CIVIL			
C-1	TITLE SHEET		
C-2	CONCEPTUAL DEMOLITION PLAN		
C-3	CONCEPTUAL PAVING AND DRAINAGE PLAN		
C-4	CONCEPTUAL PAVING AND DRAINAGE DETAILS		
C-5	CONCEPTUAL PAVING AND DRAINAGE DETAILS		
C-6	CONCEPTUAL PAVING AND DRAINAGE DETAILS		
C-7	CONCEPTUAL POLLUTION PREVENTION PLAN		
C-8	CONCEPTUAL WATER AND WASTEWATER PLAN		
C-9	CONCEPTUAL WATER AND WASTEWATER DETAILS		
C-10	CONCEPTUAL WATER AND WASTEWATER DETAILS		
C-11	CONCEPTUAL WATER AND WASTEWATER DETAILS		
C-12	CONCEPTUAL WATER AND WASTEWATER DETAILS		
C-13	CONCEPTUAL WATER AND WASTEWATER DETAILS		
C-14	CONCEPTUAL WATER AND WASTEWATER DETAILS		
C-15	CONCEPTUAL WATER AND WASTEWATER DETAILS		
PHOTOMETRIC			
ESPH-1.1	SITE PHOTOMETRIC PLAN		
PUBLIC SAFETY SECURITY / CPTED			
PS001	PUBLIC SAFETY SECURITY / CPTED PLAN		

SEAL:

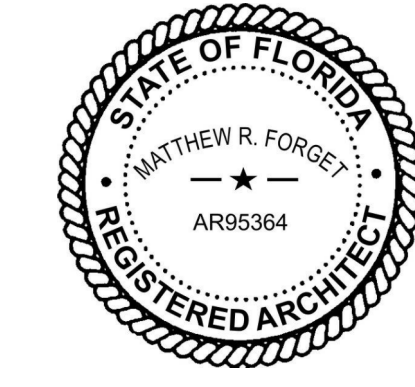

MATTHEW R. FORGET // REG. FL. NO. AR95364

DIGITAL SIGNATURE:

CLIENT / PROJECT ADDRESS:

HODGE MARINE

1857 NW 21ST STREET
POMPANO BEACH, FLORIDA 33069

REVISIONS:

NO.	DATE	DESCRIPTION
-----	------	-------------

KEY PLAN:

OWNER / CLIENT

JH4 INVESTMENTS LLC

3170 N FEDERAL HWY STE 100M
LIGHTHOUSE POINT, FL 33064

JESSICA HODGE
HODGEMARINE@GMAIL.COM
954.410.0725

ARCHITECTURE

5 ARCHITECTURE

33 SE 4TH STREET, SUITE 100
BOCA RATON, FLORIDA 33432

MATT FORGET
MATT@5ARCHITECTURE.COM
561.835.5515

SITE LIGHTING

B&K ENGINEERING GROUP

3601 NW 2 AVE
BOCA RATON, FL 33431

JUAN BEDOYA, P.E.
JBEDOYA@BK-ENGINEERS.COM
561.208.6800

CIVIL ENGINEERING

SIMMONS & WHITE

2581 METROCENTRE BLVD WEST, STE 3
WEST PALM BEACH, FL 33407

GREGORY F. BOLEN, P.E.
BOLEN@SIMMONSANDWHITE.COM
561.478.7848

LANDSCAPE

AGTLAND LANDSCAPE ARCHITECTURE

132 NORTH SWINTON AVENUE
DELRAY BEACH, FLORIDA 33444

CAROL PEREZ, ASLA
CAROL@AGTLAND.COM
561.276.5050

Autodesk Docu/Hodge Marine/24-057_Hodge Marine_205.rvt
7/1/2025 9:48:41 AM

DRC

PZ25-12000364

08/06/2025

APPROVAL
SITE PLAN

PROJECT NUMBER: 24-057

DATE ISSUED: 2025-06-30

SHEET TITLE:

COVER SHEET

SHEET NO:

G000